

# WIRING INSTRUCTIONS

**TITLE** 5378-20 1/2" HAMMER-DRILL  
**MILWAUKEE ELECTRIC TOOL CORP. 13135 WEST LISBON RD. BROOKFIELD, WIS.**

**DATE**  
 Oct. 2004

**BULLETIN**  
 58-01-1150

SEE THE BACK OF THIS BULLETIN  
 FOR INSTRUCTIONS ON HOW TO CONNECT  
 WIRES TO SWITCH NO. 23-66-1692.

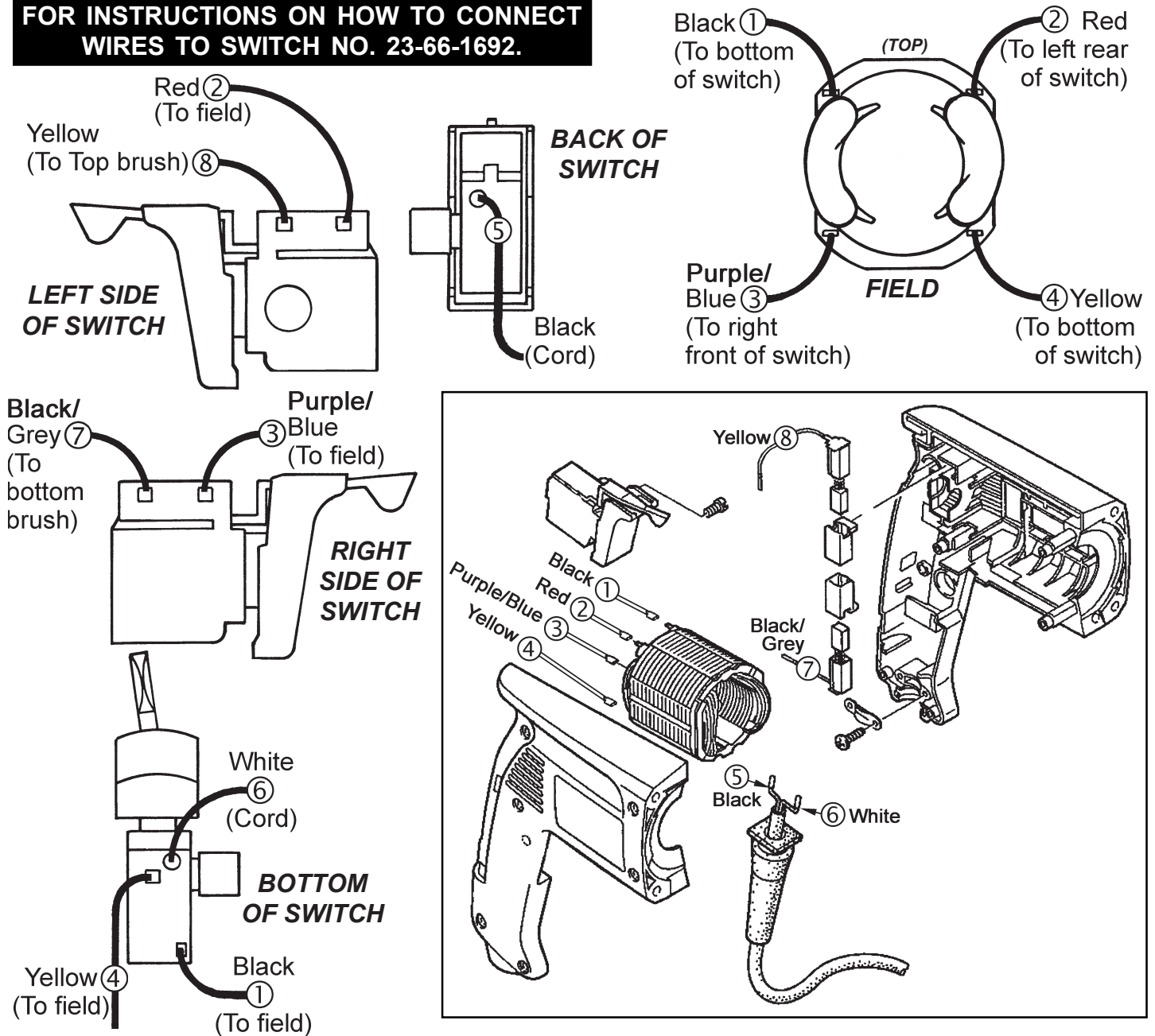

WIRING SPECIFICATIONS				
Wire No.	Wire Color	Origin or Gauge	Length	Terminals, Connectors and 1 or 2 End Wire Preparation
1	Black	18	6.25	Leadwire assembly 23-94-1045
2	Red	18	4.75	Leadwire assembly 23-94-1060
3	Purple / Blue	18	2.75	Leadwire assembly 23-94-1055
4	Yellow	18	5.25	Leadwire assembly 23-94-1050
5	Black	Cord	3.50	Component of cord set
6	White	Cord	2.25	Component of cord set
7	Black / Grey	Brush	2.25	
8	Yellow	Brush	4.25	

**NOTE:**  
 All leads must be held to  $\pm 1/16"$ .  
 All lead lengths are before stripping.

TERMINAL DESCRIPTION		
Code	Part No.	Qty.
CONNECTOR DESCRIPTION		

**BULK LEAD WIRE - BULLETIN 58-01-0003**

**SEE THE FRONT OF THIS BULLETIN  
FOR INSTRUCTIONS ON HOW TO CONNECT WIRES  
TO SWITCH NO. 23-66-1690.**

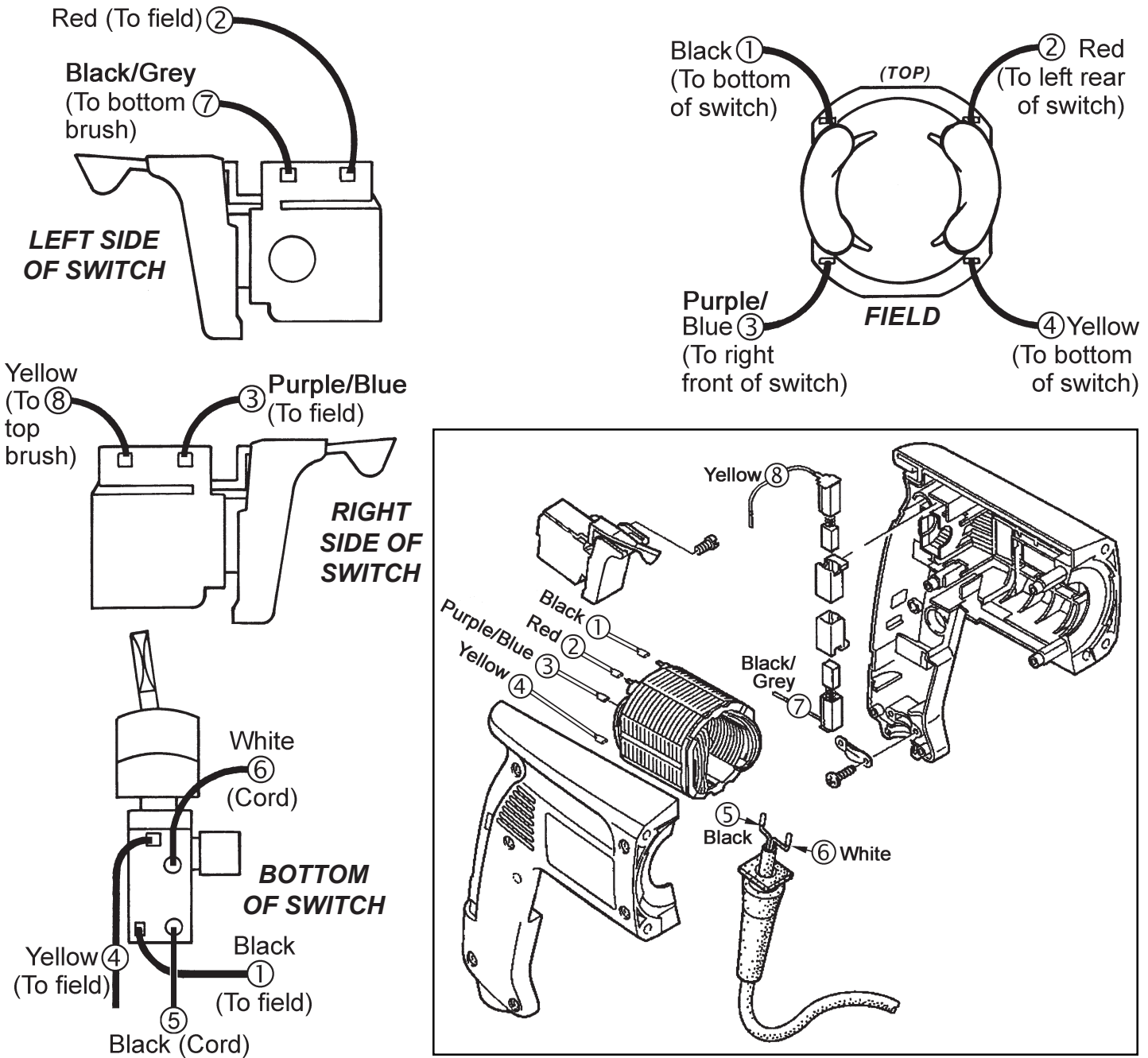

WIRING SPECIFICATIONS				
Wire No.	Wire Color	Origin or Gauge	Length	Terminals, Connectors and 1 or 2 End Wire Preparation
1	Black	18	6.25	Leadwire assembly 23-94-1045
2	Red	18	4.75	Leadwire assembly 23-94-1060
3	Purple / Blue	18	2.75	Leadwire assembly 23-94-1055
4	Yellow	18	5.25	Leadwire assembly 23-94-1050
5	Black	Cord	3.50	Component of cord set
6	White	Cord	2.25	Component of cord set
7	Black / Grey	Brush	2.25	
8	Yellow	Brush	4.25	

NOTE:  
All leads must be held to  $\pm 1/16"$ .  
All lead lengths are before stripping.

TERMINAL DESCRIPTION		
Code	Part No.	Qty.
CONNECTOR DESCRIPTION		