

WIRING INSTRUCTIONS

TITLE	SAWZALL®	BULLETIN
MILWAUKEE ELECTRIC TOOL CORP. 13135 WEST LISBON RD. BROOKFIELD, WIS.	DATE June 2007	58-01-0056

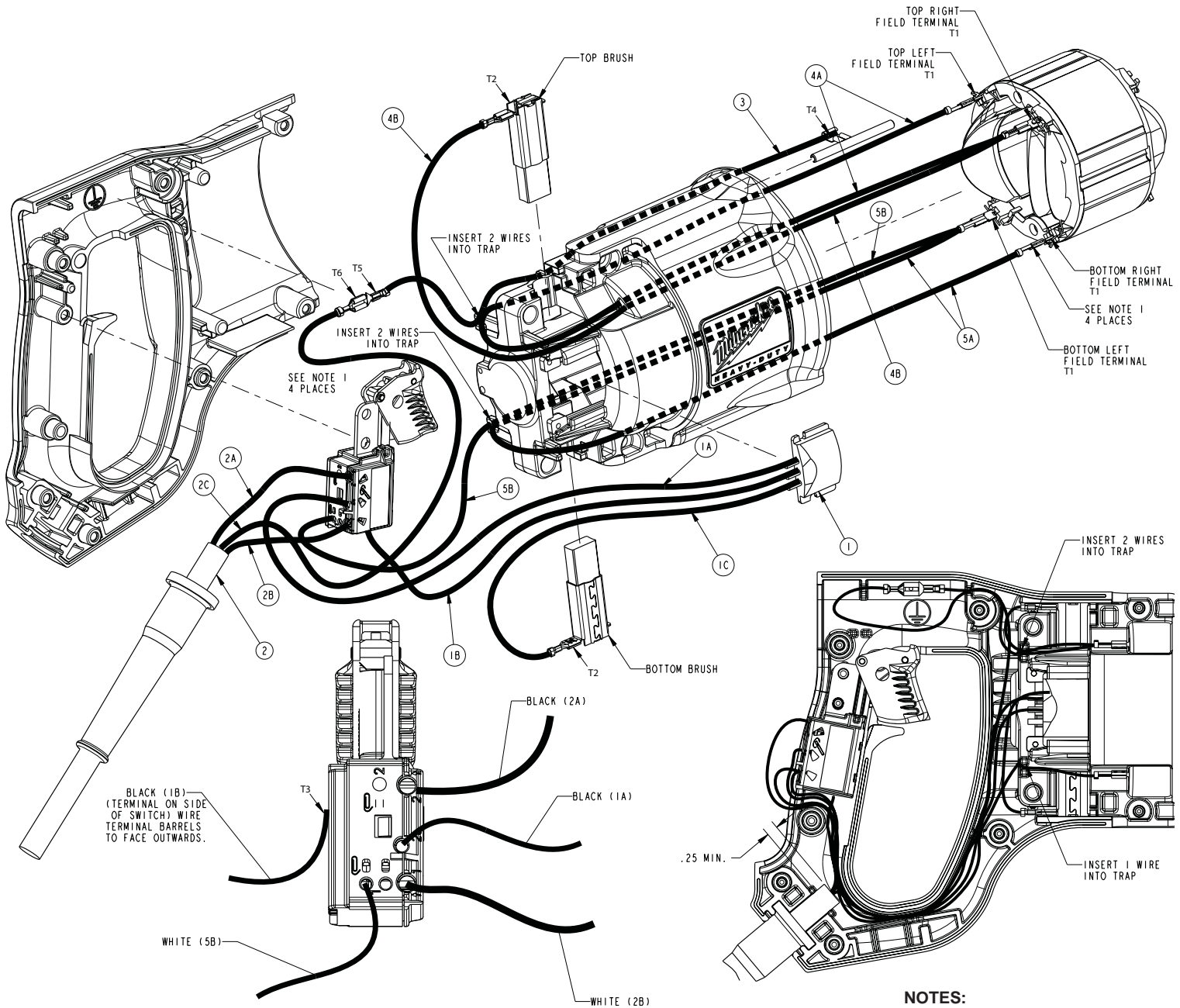

NOTES:
 TERMINALS MAY BE SECURED WITH BARRELS FACING IN OR OUT. (4 PLACES).

NOTE:
 All leads must be held to ± 1/8".
 All lead lengths are before stripping.

WIRING SPECIFICATIONS					
Wire No.	Wire Color	Origin or Part No.	Ga.	Length	Terminals, Connectors and End Wire Preparation
1A	Black	14-20-3151	18	10.25	Strip .320 and tin.
1B	Black	14-20-3151	18	9.5	Strip .19 for T3.
1C	Black	14-20-3151	18	2.40	Strip .19 for T2.
2A	Black	Cord Assembly	16	4.00	Strip .340 and tin.
2B	White	Cord Assembly	16	3.25	Strip .340 and tin.
2C	Green	Cord Assembly	16	11.25	Strip .19 for T6.
3	Green	23-94-0025	18	7.00	Strip each end .190 for T4 and T5.
4A	White	23-94-6750	18	2.90	Strip one end .19 for T2.
4B	White	23-94-6750	18	5.00	Strip one end .15 for T1.
5A	White	23-94-6755	18	9.25	Strip one .320 and tin.
5B	White	23-94-6755	18	5.00	Strip one end .15 for T1.

TERMINAL DESCRIPTION		
Code	Part No.	Qty.
T1	23-74-1060	4
T2	23-74-0017	2
T3	23-74-0010	1
T4	23-74-0605	1
T5	23-74-0105	1
T6	23-74-1095	1

BULK LEAD WIRE - BULLETIN 58-01-0003