



●= Components of the 14-46-2605 Rotary Hammer Service Kit

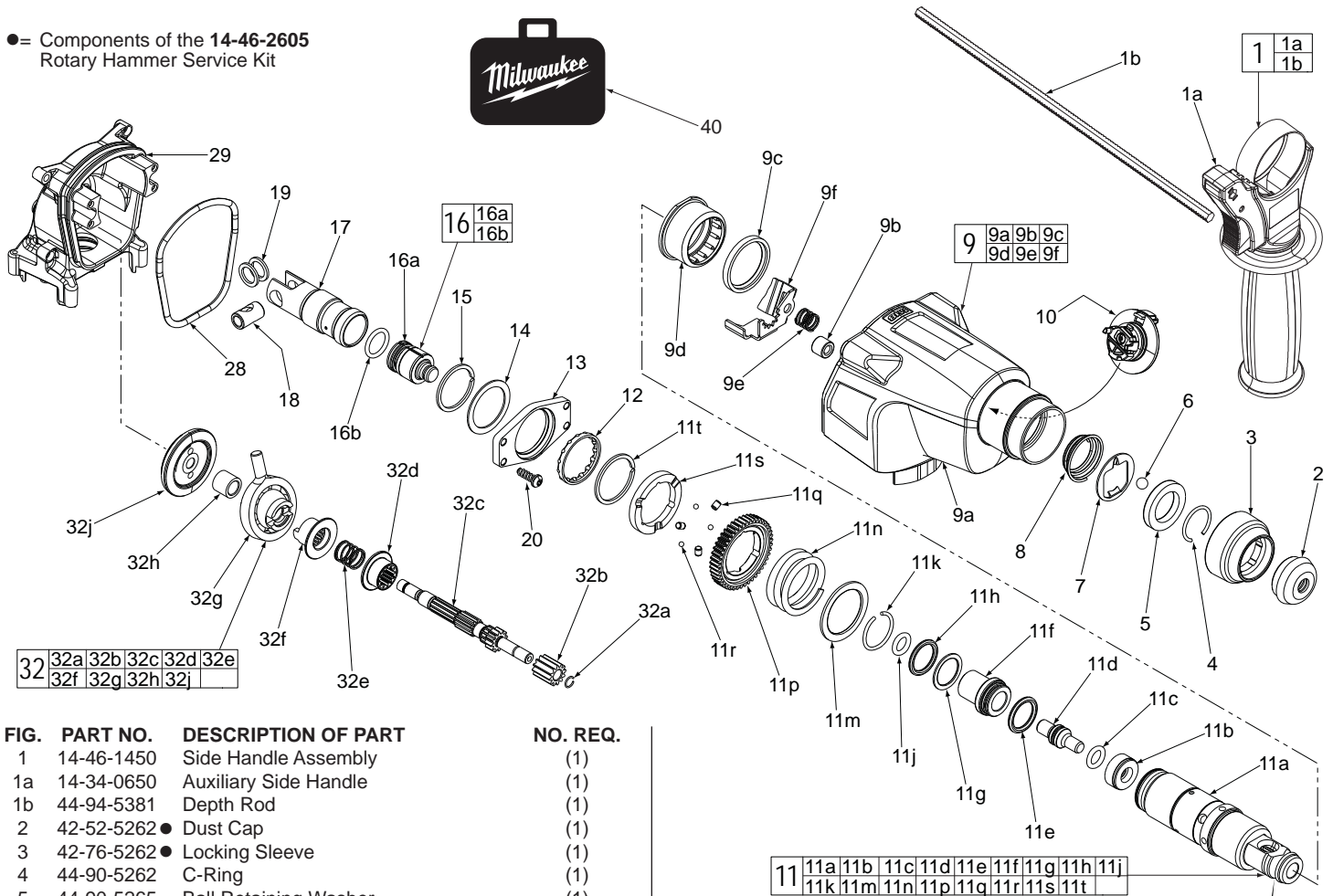

FIG.	PART NO.	DESCRIPTION OF PART	NO. REQ.
1	14-46-1450	Side Handle Assembly	(1)
1a	14-34-0650	Auxiliary Side Handle	(1)
1b	44-94-5381	Depth Rod	(1)
2	42-52-5262	● Dust Cap	(1)
3	42-76-5262	● Locking Sleeve	(1)
4	44-90-5262	C-Ring	(1)
5	44-90-5265	Ball Retaining Washer	(1)
6	02-02-0275	7mm Steel Ball	(1)
7	42-36-5262	Ball Support Plate	(1)
8	40-50-5262	Conical Spring	(1)
9	31-40-0600	Gearcase Assembly	(1)
9a	-----	Gear Housing	(1)
9b	-----	Needle Bearing	(1)
9c	-----	Oil Shield	(1)
9d	-----	Needle Bearing	(1)
9e	40-50-0870	Spring	(1)
9f	44-90-1010	Locking Plate	(1)
10	44-10-5262	Shift Lever	(1)
11	45-22-0850	Spindle Sleeve Assembly	(1)
11a	38-50-0775	Spindle	(1)
11b	45-88-2100	Stop Washer	(1)
11c	34-40-1410	● O-Ring	(1)
11d	45-08-0650	Striker (Anvil)	(1)
11e	34-40-1425	● O-Ring	(1)
11f	45-22-0870	Sleeve	(1)
11g	34-40-1440	● O-Ring	(1)
11h	42-76-1000	Thrust Collar	(1)
11j	34-40-1450	● O-Ring	(1)
11k	44-90-1025	● C-Ring	(1)
11m	45-88-2115	Washer	(1)
11n	40-50-1720	Clutch Spring	(1)
11p	32-75-1830	Spindle Gear	(1)
11q	44-96-0300	Roller	(3)
11r	02-02-1230	Steel Ball	(3)
11s	42-70-0780	Clutch Disc	(1)
11t	44-90-0215	● C-Ring	(1)
12	02-80-1750	Spindle Bearing	(1)
13	42-36-2190	Bearing Bar Mounting Bracket	(1)
14	45-88-5230	Washer	(1)
15	44-90-1030	● C-Ring	(1)
16	44-82-5262	Striker and O-Ring Assembly	(1)
16a	45-56-0300	Ram	(1)
16b	34-40-1510	● O-Ring	(1)
17	44-62-5262	Piston	(1)
18	44-60-5262	Wrist Pin	(1)
19	45-88-5200	● Washer	(2)

FIG.	PART NO.	DESCRIPTION OF PART	NO. REQ.
20	05-78-0870	● M4 x 0.7 x 24mm Taptite Screw (4 of 8)	(4)
28	43-44-1375	● Gasket	(1)
29	31-15-3100	Crankcase	(1)
32	14-73-1600	Wobble Shaft Assembly	(1)
32a	44-90-1180	● C-Ring	(1)
32b	32-60-1610	Pinion Gear	(1)
32c	36-66-1620	Reduction Gear Shaft	(1)
32d	32-60-1620	Internal Gear	(1)
32e	40-50-2140	Spring	(1)
32f	45-22-0925	Coupling Sleeve	(1)
32g	36-92-0800	Wobble Plate	(1)
32h	45-36-1825	Spacer	(1)
32j	32-05-0625	Bevel Gear	(1)
40	42-55-0050	Carrying Case	(1)

**IMPORTANT NOTE:**  
When installing 'C' ring #4 onto spindle #11a be sure to position the "C" ring opening 180° from steel ball #6.

SCREW TORQUE CHART			
Item	Part Number	Where Used	Seat Torque (In./Lbs.)
20	05-78-0870	Mounting Bracket	43-52
20	05-78-0870	Motor Hsg. Cover & Support	21-26
21	05-74-1020	Crankcase Ball Bearing	20-24
24	05-74-1030	Bearing Cover	35-43
27	05-74-1060	Gear Housing Cover	13-18
33g	05-78-0910	Bearing End Plate	24-30
39c	05-81-5262	Motor Housing Cover	13-15

**LUBRICATION NOTES:** Type 'Q2' Grease  
No. 49-08-5345, 1.5 oz./45g tube

**NOTE:** The entire contents of the grease tube will not be used. Use a total of approximately 3/16 oz./5.4g.

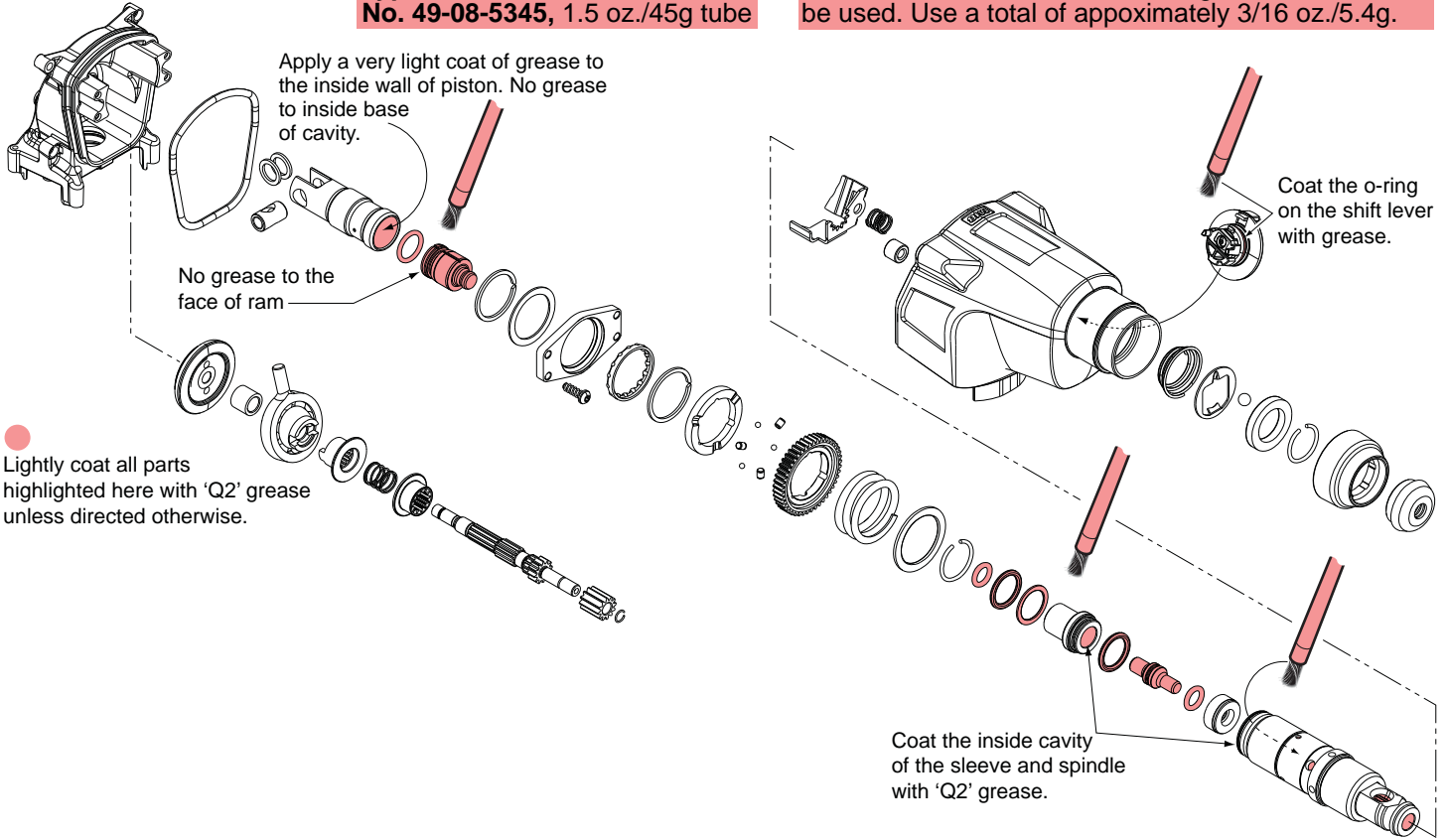

**LUBRICATION NOTES:** Type 'P' Grease  
No. 49-08-5350, 3.5 oz./100g tube

**NOTE:** The entire contents of the grease tube will not be used. Use a total of approximately 2 oz./59g.

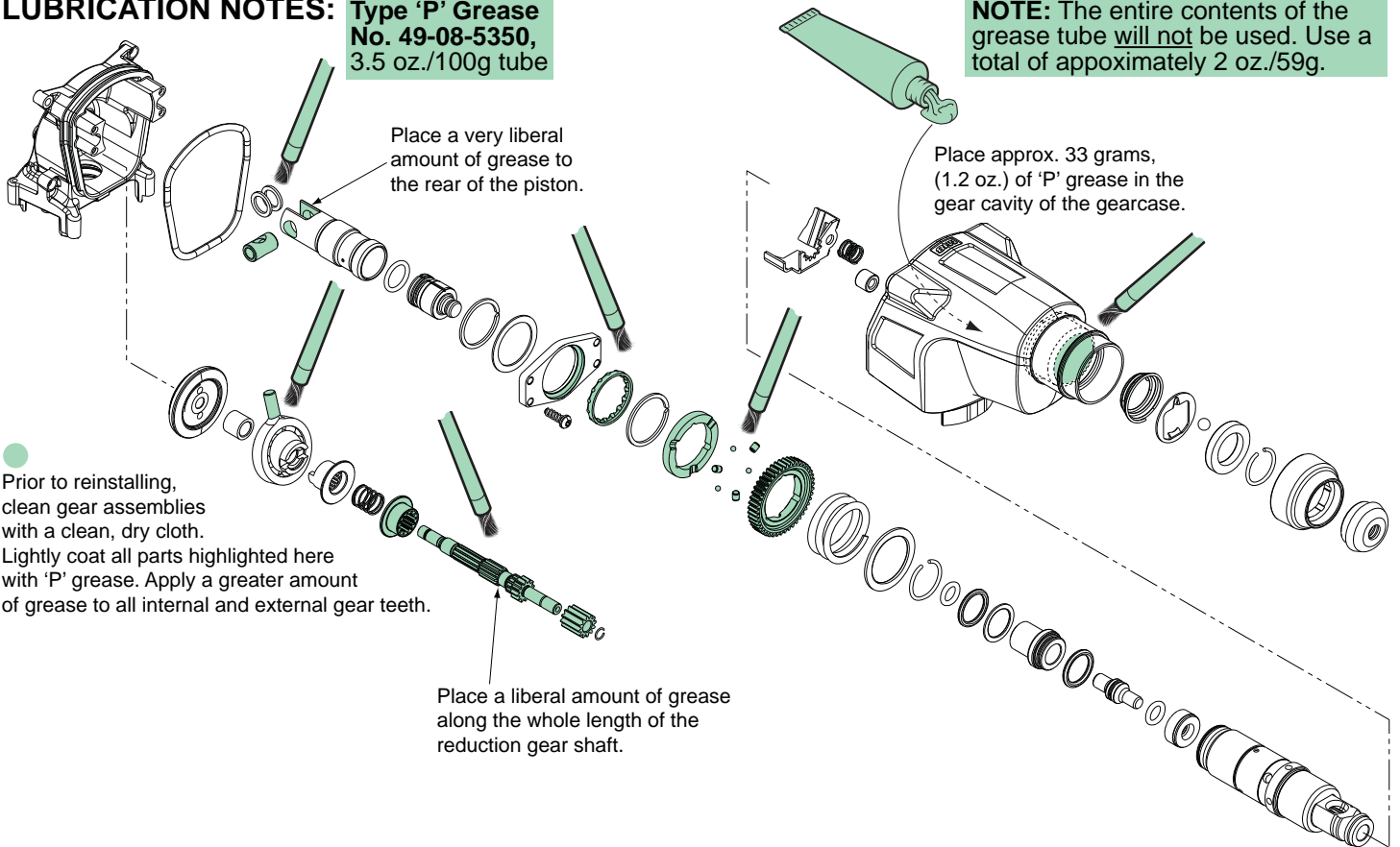

 = WIRE TRAPS

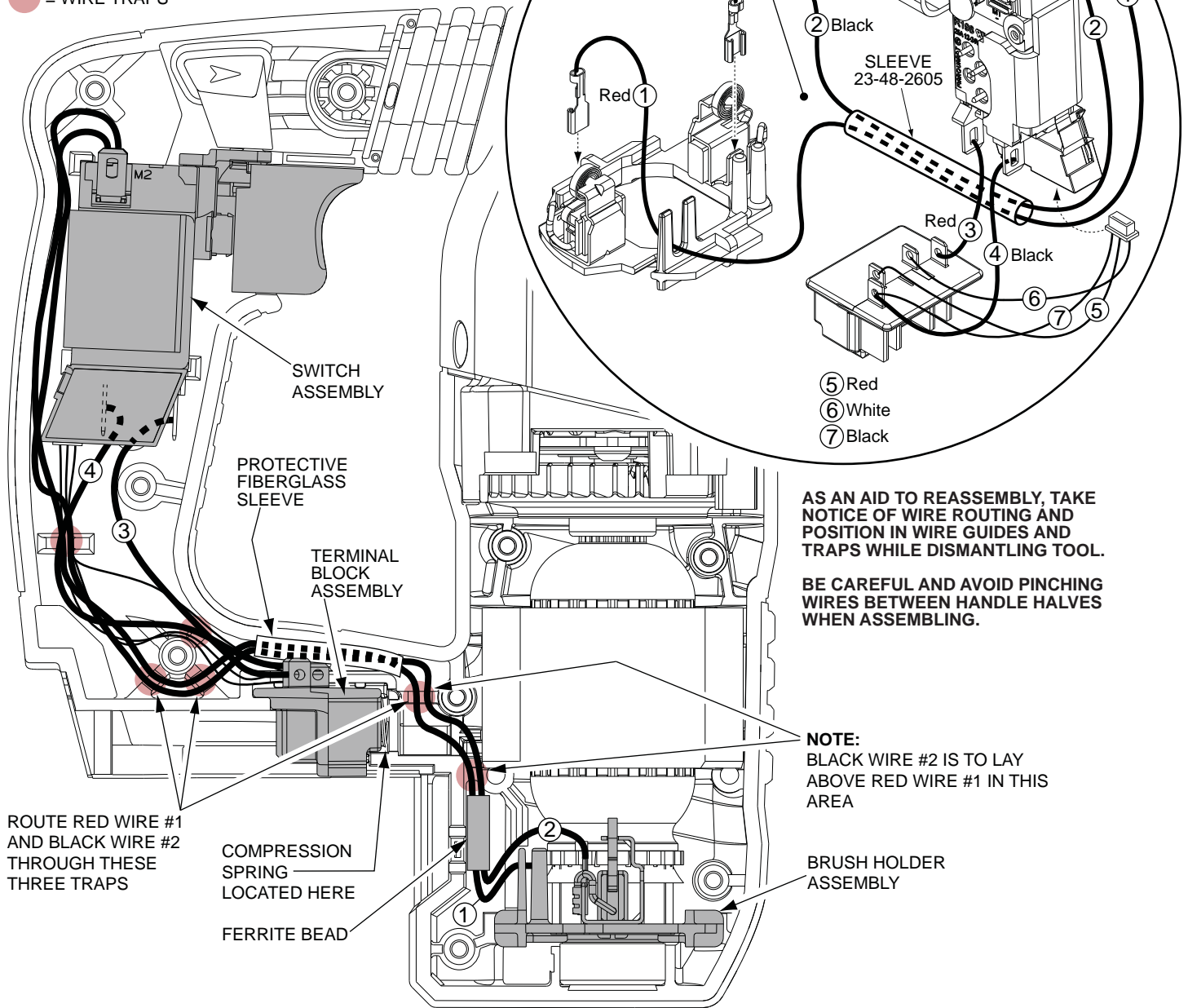

### WIRING SPECIFICATIONS

Wire No.	Wire Color	Origin or Gauge	Length	Terminals, Connectors and 1 or 2 End Wire Preparation
1	Red	23-94-1970	-----	Components of Switch and Terminal Block Assembly or... Wire #1: Solder stripped end to 'M2' position on top of switch. Connect terminated end to left brush.
2	Black	23-94-1975	-----	Wire #2: Solder stripped end to 'M1' position on top of switch. Connect terminated end to right brush.
3	Red	23-66-3010	-----	Component of Switch and Terminal Block Assembly. Route wire in left handle half as shown.
4	Black	23-66-3010	-----	Component of Switch and Terminal Block Assembly. Route wire in left handle half as shown.
5	Red	23-66-3010	-----	Component of Switch and Terminal Block Assembly. Route wire in left handle half as shown.
6	White	23-66-3010	-----	Component of Switch and Terminal Block Assembly. Route wire in left handle half as shown.
7	Black	23-66-3010	-----	Component of Switch and Terminal Block Assembly. Route wire in left handle half as shown.